

The Aqua Temperature Sensor and Shield

By equipping your Aqua ET Controller with an Aqua Temperature Sensor, your controller will receive temperature readings that will allow for more accurate landscape water management.

Your Aqua ET Controller uses temperature with ET (evapotranspiration) data to change the duration of watering based on local weather data.

The shield protects the sensor from people and allows air movement past the sensor.

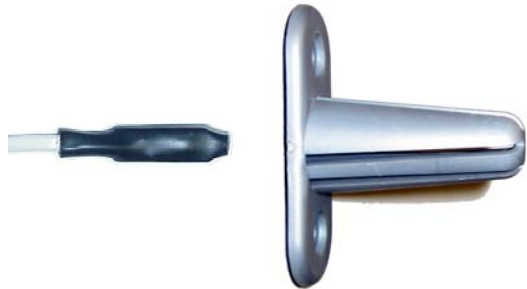

The Aqua Temperature Shield

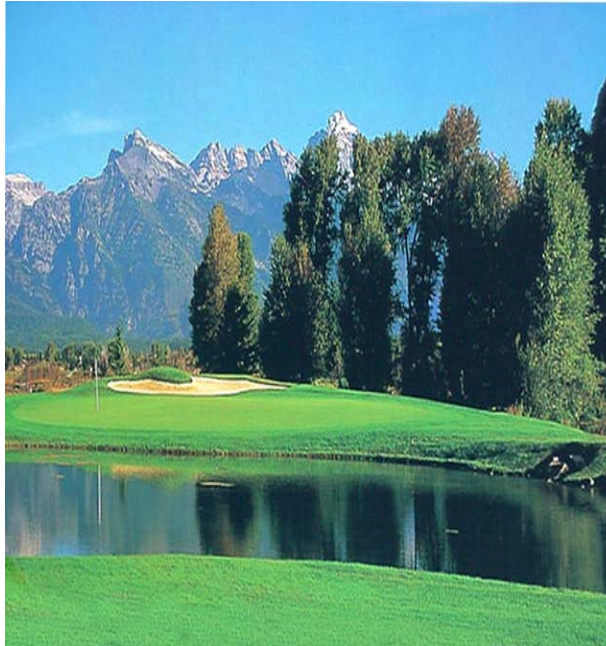

AQUA
Conserve

2900 Adams Street, Suite A-25
Riverside, California 92504
For customer information call
Toll Free: (877) 922-2782
(951) 352-3891 Fax: (951) 352-4345
© 2004-2007

Or visit us on the web at
www.aquaconserve.com

Part No. MAN-0022 Rev.4
Printed 01/03/2007

The Aqua Temperature Sensor

The Aqua Temperature Sensor modifies the historic data used to determine landscape water needs on a daily basis and adjust for warmer or colder seasons.

- Will further increase your water savings
- Will more accurately determine your landscape water needs each day.
- Will allow you to reduce summer run-time minutes even further.



Temperature Sensor comes in 5' and 25' cable lengths.

The Aqua Temperature Sensor Shield

Installation Instructions

The best location for the sensor is out of direct sunlight. The shield should be mounted under the irrigation box or on the side that does not have direct sun light. Do not mount the sensor on the top of the enclosure.

Use the drill pattern below to make the mounting holes for the shield. The two outside holes are for 1/4 inch screws, and the center 3/8 inch hole is where the temperature sensor goes into the shield.

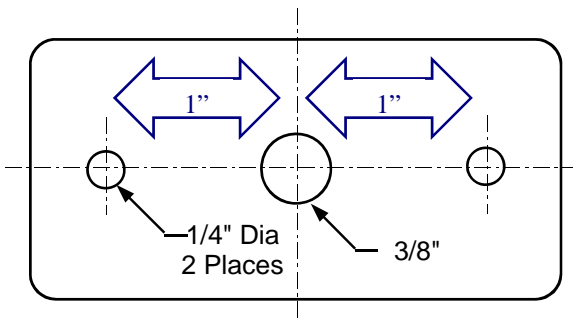

Modular Socket

Step 1 Drill the two 1/4 inch holes and the one 3/8 inch hole through the side of the enclosure.

Step 2 Mount the shield onto the enclosure using the two screws and nuts provided.

Step 3 Pass the end of the sensor through the center hole. The black portion of the sensor should be completely inside of the shield.

Step 4 Connect the plug end of the cable into the socket as shown below until the connector snaps into place and cannot be removed by a light pull.



ET-16-32

Step 5 Coil the remaining cable inside the enclosure. (be careful not to stress or create tension at the modular connector plug-in.)

Step 6 After placing the sensor into the shield you might want to place putty or other sealant around the cable to prevent bugs from entering the irrigation enclosure.

IMPORTANT NOTE: To insure maximum accuracy from your Aqua Temperature Sensor, *PLACE the shield OUT of DIRECT SUNLIGHT.*

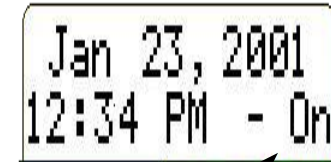

IMPORTANT NOTE: After installation of the Aqua Temperature Sensor, this part of the LCD display will change from “ON” to a temperature reading. If rain delay is present, this part of the display will show “OFF”.

Package Contents:

One Temperature sensor Shield
Two 1/4" screws
Two 1/4" nuts

Tools Needed for Installation:

Electric or Battery Powered Drill
1/4" Drill Bit
3/8" Drill Bit
Philips Screw Driver
9/16" or Adjustable Wrench

Product Compatibility:

The Aqua Conserve Temperature Sensor & Shield can be used in conjunction with the following Aqua ET Controllers.

Model Numbers:

ET-8, 12, 16, 24, 26, 32, 36, 46,
56 and 66 Station Controllers